

REDHAWK SE

CLASS C MOTORHOMES

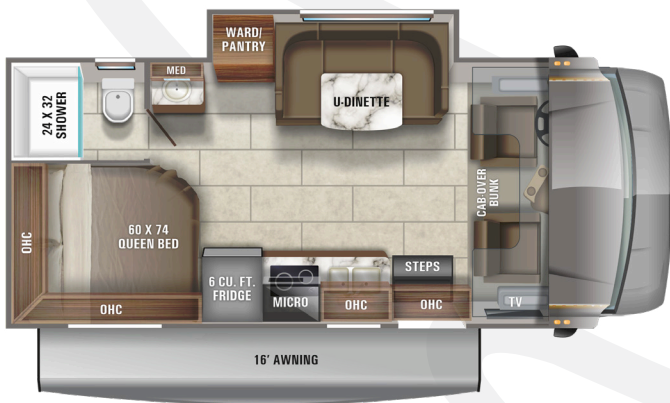

22A

Ext. Lgth: 25' 2" Wheelbase: 159" GVWR: 14,200 lbs.

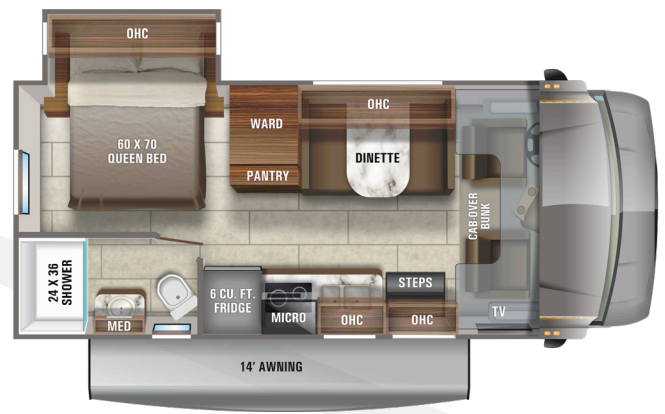

22C

Ext. Lgth: 25' 2" Wheelbase: 159" GVWR: 14,200 lbs.

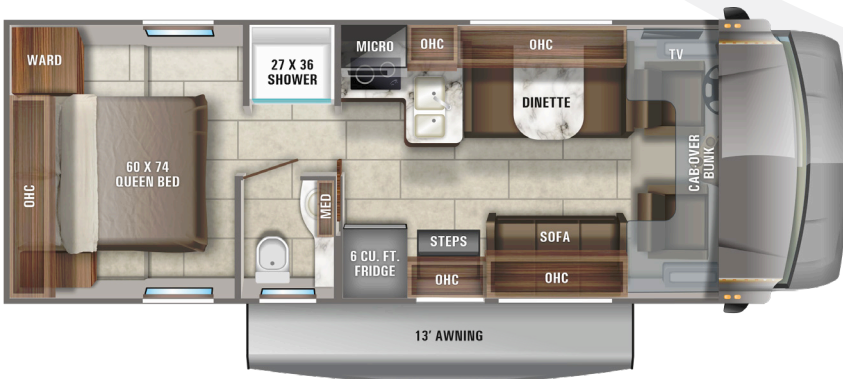

27N

Ext. Lgth: 30' 3" Wheelbase: 191" GVWR: 14,200 lbs.

EXTERIOR GRAPHICS PACKAGE



STANDARDS & OPTIONS

CUSTOMER VALUE PACKAGE

One-piece, seamless, fiberglass front cap
 Heated holding tanks (12V pads)
 Electric patio awning
 Black holding tank sprayer
 Backup camera
 6 cu. ft. flush-mount refrigerator
 LED HDTV

STANDARD DRIVING EQUIPMENT

Chevrolet® 4500 chassis
 GVWR- 14,200 lb.
 GCWR- 20,000 lb.
 6L Vortec V8 342 HP engine with
 373 ft.-lb. torque
 Hydra-matic 6-speed automatic transmission
 with overdrive
 120-amp alternator
 E-rated highway tires- LT225/75R16
 Power anti-lock brakes with power steering
 5,000 lb. hitch with 500 lb. tongue capacity
 and 7-pin plug
 12V chassis battery
 57 gal. fuel tank
 Remote-controlled, side-view mirrors
 Driver and passenger air bags
 Power windows and door locks
 Tilt steering wheel
 A/C and cruise control
 Auxiliary start switch
 Privacy curtains for cab area

STANDARD EXTERIOR EQUIPMENT

StrongholdVBL™ Vacuum-Bond laminated
 roof, floor and sidewalls
 Bead-foam insulation (R-15 max roof, R-9 max
 floor, R-5 max walls)
 TPO laminated roof
 Aluminum running boards
 Fiberglass exterior walls with vinyl graphics
 Leveling jack prep
 Entrance door with industry's largest travel
 view window
 Electric-powered entrance step with integrated
 house battery compartment
 12V house battery
 12.2 gal. propane tank (41 lb.)
 LP quick-connect hookup
 Exterior utility center
 Winterization drain system
 Outside shower
 12V demand water pump
 Onan® 4,000-watt MicroQuiet™ generator
 30-amp electrical service
 Solar prep
 Third brake light
 Porch light
 Roof ladder
 4 in. bumper tube sewer hose storage

STANDARD INTERIOR EQUIPMENT

84 in. ceiling height
 High-intensity, recessed LED ceiling lights
 Hardwood cabinet doors

Ball-bearing drawer guides
 Jayco-exclusive, easy-operation legless
 dinette table
 2-point lap safety belts in all designated
 seating locations
 Interior entrance door grab handle
 Interior command center
 Pleated blackout shades
 13,500 BTU ducted A/C
 31,000 BTU auto-ignition furnace
 6 gal. gas/electric DSI auto-ignition water heater
 Cable TV hookup with RG-6 coax
 Digital antenna with signal booster
 2-burner cooktop with flush cover
 Convection microwave oven
 Stainless steel kitchen sink
 Decorative kitchen backsplash
 Water filtration system
 Shower with decorative ABS surround
 and skylight
 Stainless steel bathroom sink
 Toilet with foot flush
 Queen-sized bed with bedspread
 Under-bed storage (select models)
 Large wardrobes
 Overhead bunk with 750 lb. capacity
 Smoke alarm
 Carbon monoxide detector

OPTIONS

Hydraulic leveling jacks

REDHAWK SE FLOORPLANS	EXTERIOR LENGTH	EXTERIOR WIDTH	EXTERIOR HEIGHT (WITH A/C)	INTERIOR HEIGHT	WHEEL BASE	FRESH WATER CAPACITY (INCLUDING WATER HEATER)	GRAY WASTE WATER CAPACITY	BLACK WASTE WATER CAPACITY
22A	25' 2"	100"	11' 6"	84"	159"	43	40	32
22C	25' 2"	100"	11' 6"	84"	159"	43	40	31
27N	30' 3"	100"	11' 6"	84"	191"	39	41	32

Some specs at the time of print may include estimates, for the most updated information, please visit Jayco.com

It is important for your safety and enjoyment that you are aware of the weights and tow ratings of the RV you select. Consult a competent advisor for questions or advice. Whether you are new to RVing or a veteran, get a feel for the performance of your RV before heading out on the roadways. When you tow a vehicle with your RV, you must drive differently than when you drive a single vehicle. Practice hooking up, driving, backing up and braking in a safe environment or seek out professional instruction. Jayco affixes a weight label to each RV which lists weight information for that vehicle. Refer to that label to verify the vehicle will meet your requirements. See specifications chart above.

Gross Vehicle Weight Rating (GVWR): The maximum permissible weight of the motorhome, including the Unloaded Vehicle Weight (UUV) plus passengers, personal items, all cargo, fluids, options and dealer-installed accessories. The GVWR is equal to or greater than the sum of the UUV and the Cargo Carrying Capacity.



TRAVEL WITH CONFIDENCE • NO ONE OFFERS A BETTER WARRANTY

At Jayco, we build our RVs to handle every adventure, then back them with our industry-leading 2+3 limited warranty. Our 2-year limited warranty has you covered for 2 camping seasons. That's 730 days. In addition, our 3-year structural limited warranty has you covered for 3 camping seasons or 1,095 days. You won't find a better limited warranty in the business, because the only strings that we attach are those that deliver the ultimate in reliability. That's the Jayco difference. So go explore. For a copy of our 2-year limited + 3-year limited structural warranty with complete terms and conditions, please contact your local Jayco dealer.



Generations of family fun.

